

# Live Riveted

Dream. Travel. Explore. Live.

Your Airstream adventure awaits...







# International range



## Missouri

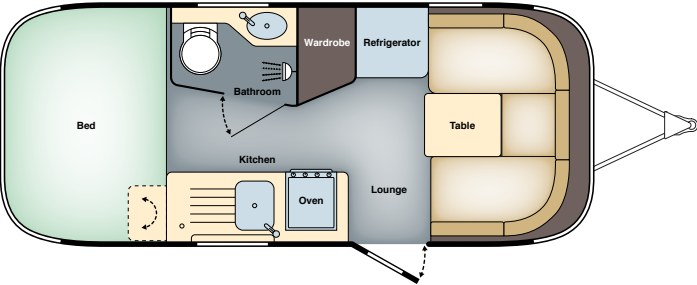

## Yukon

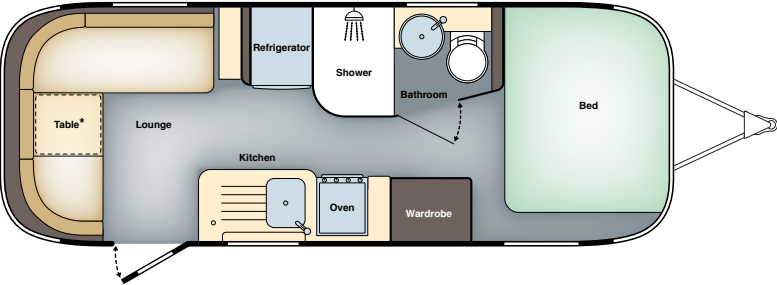

\*Table transforms to become the base for the L-shaped seating arrangement.



## Colorado

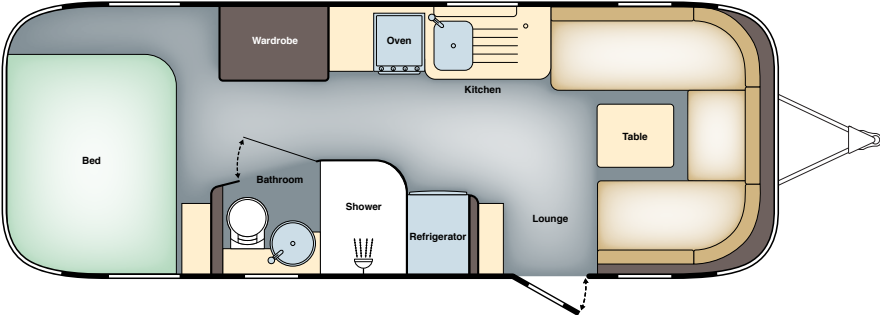





Manhattan Impala



Americana Leather



Manhattan Leather





Specifications	Missouri	Yukon	Colorado
Berths	4	2 / 3	4
Axles	1	2	2
Internal Length	5.32m	6.03m	6.81m
Overall Length*	6.81m	7.60m	8.25m
Overall Width*	2.29m	2.29m	2.50m
Overall Height*	2.65m	2.65m	2.65m
Internal Headroom	1.99m	1.99m	1.99m
Mass in Running Order	1645kg	1900kg	2165kg
Maximum Technical Permissible Laden Mass (MTPLM)	1830kg	2100kg	2400kg

The Mass in Running Order (MRO) comprises:  
1. The mass of the empty caravan as supplied by Swift including loose items such as the hook-up cable, kit bag, entrance step, manuals etc  
2. 19.8kg allowance for LPG  
3. 35kg allowance for water in the fresh water tank.  
4. 8.4kg allowance for water in the water heater.  
The MRO is calculated with the fresh water tank and boiler full but the toilet flush tank empty. If you travel without water in the fresh water tank the payload can be increased proportionally.

The Maximum Technical Laden Mass (MTPLM) is the maximum mass allowed when the caravan is fully laden.  
WARNING: Under no circumstances should the MTPLM be exceeded.  
The masses are calculated in accordance to EU regulation 1230/2012 and NCC code of practice 304.  
\*The dimensions and weights given are approximate due to slight variations in suspension ride heights, loading conditions and tyre pressures.

Customers should verify the actual dimensions of their touring caravan before committing to anything that could be impacted by theses dimensions  
Please note: Any dealer fit options will reduce the overall payload available to the user of the caravan. If you require additional payload it is possible to upgrade the MTPLM to the upper limit. Please contact your Airstream dealer for more information.

## Exterior Features

- Handcrafted buck riveted aluminium bodyshell, timeless iconic design
- Rounded aerodynamic shape for superior towing performance
- Fluoropolymer clear coated aluminium panels inside and out
- Semi-monocoque all aluminium superstructure
- Hand crafted Airstream welded extruded aluminium window frames
- Tempered tinted windows with double cam latching system
- Custom handcrafted 0.66m wide one-piece entry door with window and cast hinges
- Hassle free ZipDee® patio awning
- Fixed aluminium ‘Thule’ entrance step
- European specification chassis with overrun brakes and composite insulated floor
- Thermal barrier protection between interior and exterior
- Temperature reducing one piece white aluminium roof
- Use of portal windows to optimise natural light

- Stainless steel front stone guard protection
- Chrome beltline and rub rail with insert
- Polished rear aluminium bumper
- Rear registration plate bracket with light
- Cast aluminium rear light housings
- Stainless steel front and rear grab handles
- Aluminium entry door handle
- LED entrance door light
- Handcrafted aluminium fly screen door
- Aluminium LPG gas storage locker
- 15" Alloy wheels
- Spare wheel and tyre including underslung wheel carrier
- Exterior access battery box featuring pull out tray with provision for 2 leisure batteries
- Exterior under bed access locker with chequer plate lining to floor under bed
- Exterior shower with hot and cold water
- Exterior gas BBQ connection point



## Interior Features

- Complete aluminium interior walls and ceiling
- Wrap around panoramic front and rear windows
- 1.99m Internal headroom
- Hand crafted Italian Lite-Ply laminated interior cabinetry
- Stylish Corian® work surfaces with drain grooves
- Choice of ‘Americana’ or ‘Manhattan’ leather upholstery schemes
- Individually designed seating areas with comfort and functionality in mind
- Contemporary rugs to lounge areas
- Duvalay Duvalite mattress with lightweight memory fibre technology
- Fully adjustable table with telescopic leg for use with bed make up
- Heki rooflights utilised in front and rear
- Oceanair Railshade blinds to side windows
- Seamless vinyl flooring
- Low energy LED interior lighting
- Overhead roof lockers with LED accent lighting
- Directional LED reading/courtesy lights
- Under seating storage access from entrance area
- Backrest ventilation boards
- Hinged washroom door with frosted window
- Corian® kitchen worktop with under counter mounted Franke stainless steel sink & Corian® lid
- Corian® bathroom worktop with integral Corian® bowl

## Safety and Security

- Stabilising tow hitch
- Smoke alarm
- Carbon monoxide detector
- CRiS identity number labels on windows and caravan chassis
- Keyed deadbolt locking system

## Equipment

- ALDE central heating and water heating with LCD touchscreen control with daily programming
- Dometic 3 Burner cooktop with separate oven and grill
- Dometic CK150 extractor above cooker
- Sargent EC500 power supply unit with touchscreen control panel
- Dometic 110 litre fridge incorporating 12 litre removable freezer compartment (Missouri)
- Dometic 190 litre fridge with 35 litre freezer compartment (Yukon & Colorado)
- 35 litre on-board fresh water tank
- Radio/CD/MP3 Player with audio input and Bluetooth capabilities.
- Audio speakers set into end roof lockers
- Lounge TV station with 230V, 12V and aerial sockets
- Bedroom TV station with 12V and aerial socket in bedroom
- Status 570 directional aerial
- Under locker mounted kitchen roll holder
- Size adjustable cutlery tray for optimal use of storage
- Centrally heated stainless steel washroom radiator (Yukon & Colorado only)
- Brushed steel washroom accessories (model specific)
- Eco-Camel orbit shower head
- 12V washroom ventilation fan
- Thetford C260 china bowl cassette toilet with electronic flush
- Provision for roof mounted air conditioning unit
- Provision for roof mounted solar panel
- Provision for roof mounted satellite dish (Yukon & Colorado)
- Airstream branded entrance mat
- 13 Pin ‘Jaeger’ 12v car connector





[airstream-uk.co.uk](http://airstream-uk.co.uk)

Product information, specifications and photography in this brochure were as accurate as possible at the time of printing. Photographs may contain some features that are options on your vehicle. All props are for photographic purposes only and are not included in the specification.

Since we continually strive to improve our products, actual products may differ. Prices and specification are subject to change without notice. All capacities are approximate and dimensions are nominal.

All content and images

© Airstream and Lowdham Outdoor Leisure Limited  
Issued August 2019.

adventure, inspired by  
 **AIRSTREAM**

Sole Official UK Dealership **Lowdham's**  
First for outdoor leisure